

TOMMY WHITTLE STAND TRIPLE BOX

Located on the contemporary 4th floor within the Tommy Whittle Stand, this modern triple box boasts stunning views overlooking the racecourse, comfortably catering for smaller meetings for up to 40 delegates.



THEATRE

-



BOARDROOM

30



CABARET

30



CLASSROOM

30



DINNER

40



DINNER DANCE

-



U SHAPE

-



RECEPTION

-



FLOOR PLAN

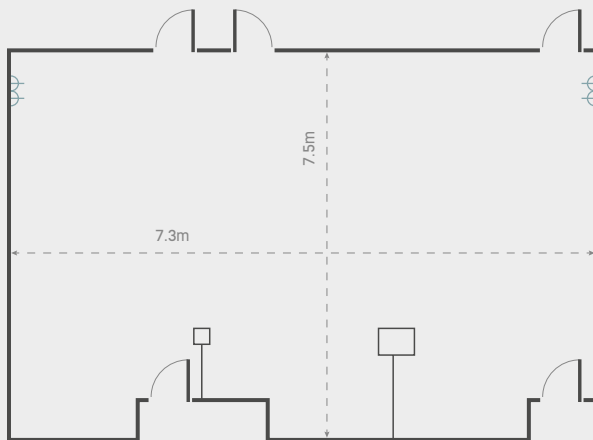

13A SOCKET

--- USEABLE SPACE DIMENTIONS

CONTACT US ON: 01942 402623 | NORTHWESTEVENTS@THEJOCKEYCLUB.CO.UK